

Model Pro.

Simplify.

Next gen dental unit.

**Meet the next
gen dental unit
that will simplify
your clinic's
workflow.**



Model Pro.



**The world's first fully digital dental unit.
Designed by a team of ergonomics researchers,
craftsmen and technology innovators.**

Pioneer in the connected dental workspace.



It's like having a new team member in the room.

The Model Pro is the first fully digital dental unit in the world.

Use interface integrated Connect App to access patient data, automate the unit and set up your smart instruments.



Connect App by Diplomat.



**Control your tools,
access patient
data, automate
your dental unit.**

Smart App, Integrated

Connect App is integrated into the Model Pro and helps you control and automate your dental unit and smart instruments.

Smooth workflow

Access patient data, X-rays, photos and more at a touch of a button. Reconfigure the chair with programmable controllers and automated chair movement.

Tec Studio

The next gen support is digital. Instant diagnostics, remote support and a database of guides and service videos.

Design meets innovation

Diplomat is a collective of dental ergonomics researchers, craftsmen and tech innovators.

Lift & rotate. Convertibility that only takes seconds.



**Easy.
Convertibility.**

Convert from
left to right in
30 seconds.



**Soft & firm:
ergonomics
rooted in
advanced
research**

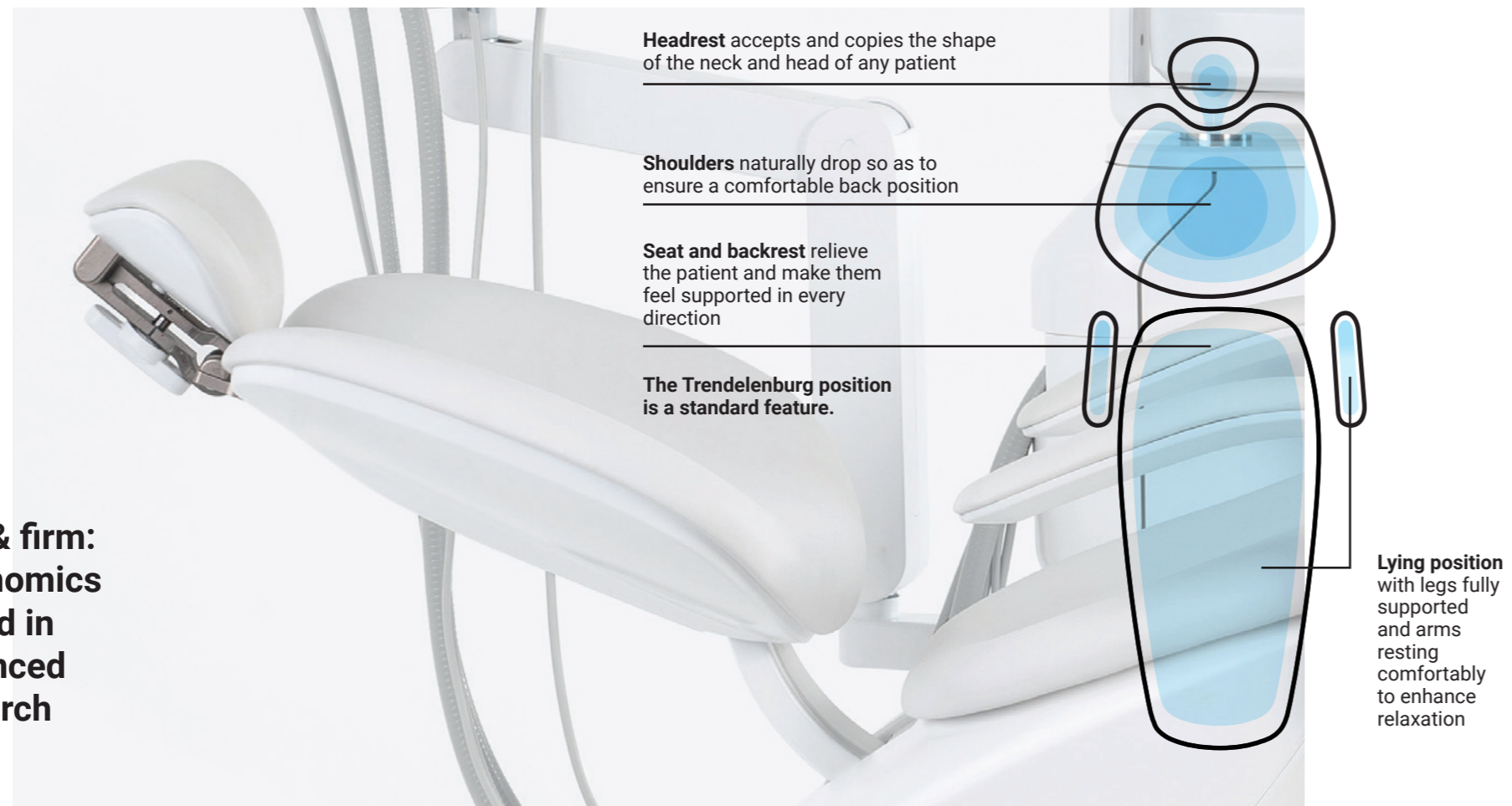

Ergonomic design for optimal patient positioning.

We spent a good deal of time conducting in-depth research of patient ergonomics, and extensively tested all of the unit's shapes and materials. As a result, our chair ensures maximum comfort, reducing patients' physical strain and their (plus your!) levels of stress. For example, did you know that when your patient's head is relaxed, so are their shoulders and back?

Researched down to the finest of details, your new chair will allow for comfortable yet firm patient positioning for all different body types (height, size, weight), and for extended periods of time.





Move easy.

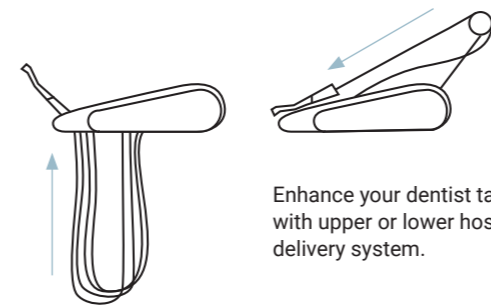

Enhance your dentist table with upper or lower hose delivery system.

Here are some of the cool features of the Model Pro that will make your day easier.

Smooth movement. Thanks to using a pneumatic spring in the pantographic arms and rolling bearings on rotary components, the movement is surprisingly smooth and pleasurable. Move easy.

No pull back. Completely new construction of whips and re-balancing of instruments places no strain on your arms and wrists whatsoever – there is no pulling back by your whips.

Stability and firmness. Vibrations are minimised, being transferred from the chair to the rest of the unit.

Your chair can be configured with up to six instruments, and the design of the dentist table ensures intuitive work, with all your instruments at the reach of your hand – it doesn't matter if you choose upper or lower hose delivery.





Space and control for your assistant or your full surgical team.

We haven't forgotten about your team either, no matter if that's one assistant who helps you with the simple fillings, or a team doing complex oral surgery. Thanks to the well-designed base, arm and body of the unit, there's more than enough space for multiple people to work around the chair.

The flexible arm allows for optimal positioning of suction hoses or instruments during any procedure. Assistant's table accommodates up

to six instruments as standard on each unit. The arm can be equipped with basic controllers for cup filling and bowl rinsing, or even a full control panel with all necessary controllers for an assistant to simplify the dentist's work.

Pantographic version is suitable for both two-handed and four-handed operations.

Space and movement details, your new chair for team movement.

There's more than enough space for multiple people to work around the chair.



- 📏
- 📏
- 📏
- ☀️
- 👁️

Easy grounding, less installation.

Don't worry about installation. Due to the special design of the chair, non-convertible models can be installed without grounding of the system. This solution is ideal for places where any drilling into floor is not allowed.





Simplify your daily maintenance.

Model Pro feels great to use even during the most mundane tasks. Designed by award-winning designers, ergonomists and engineers, we also thought about your daily maintenance routines. Model Pro can accommodate any suction system you would like. DRY systems like Cattani, Durr CS1 or amalgam separators Metasys MST1 or Durr CAS1 are available. WET systems made of Durr valves can be installed as well. Suction hoses have a double selection valve activation system integrated, so only the one you are using is active. Infection control

system is fully integrated so suction hoses can be flushed after each patient to get ready for next one in moments.

Easy handling, hassle-free maintenance: Discover Satisfaction. Suction system filters of Model Pro are easily accessible from the outside. Clean and replaced within 10 seconds. No central water supply? No problem! You don't need to reach and touch the distilled water bottle anymore – the filling is done from the top of the cuspidor. Topping up the distilled water just became fast and safe.



Connect

Bring your clinic into the 21st century.

The Connect App is open to all the smart tools you'll need to use in your practice – today or in years to come.



Load & Play

1

Download the App
Diplomat Connect.

2

Activate Bluetooth.

3

Ready!
Your dental unit is
ready to take off.



"Diplomat Connect" is available for iPad on the App Store or Android App on Google play.

Digitise your practice through a simple tablet and get the most advanced and user-friendly control system for dental units available in the market.

Use your own tablet to control your dental unit and instruments. Both Android and iOS are fully supported. Data backup on iCloud or Android drive. Quick and secure access to patient data, X-rays, photos. Automatic updates, unlimited amount of users and a friendly interface.



"Workflow focused, intelligent, open, and modular – these are the guiding principles of the Model Pro."

"Our product philosophy is to focus on open platforms, modular and intelligent solutions that improve the workflow of your dental office – making advanced technologies and smart tools easy to use and accessible to every dentist."

Tomas Nerad, CEO - Diplomat Dental



DIPLOMAT DENTAL SOLUTIONS

Discover satisfaction.



DIPLOMAT DENTAL s.r.o.
Vrbovská cesta 17, 921 01 Piešťany
Slovak republic

T 00421 33 79 54 111
F 00421 33 77 26 326

info@diplomat-dental.com
www.diplomat-dental.com



EUR-MED SLOVAKIA, s.r.o.
Športová 503, 916 01 Stará Turá
Slovak republic

Office
Vrbovská cesta 17, 921 01 Piešťany
Slovak republic

T 00421 33 79 54 820-5
F 00421 33 79 54 809

cis@eur-med.sk
www.eur-med.sk

dealer: